

Type and Type Holders

- Made of high shock alloy steel
- To order single type pieces, use the part number below and add the desired character
- For example: 1/16" letter "C" is 27630C

1/4" CHARACTER TYPE

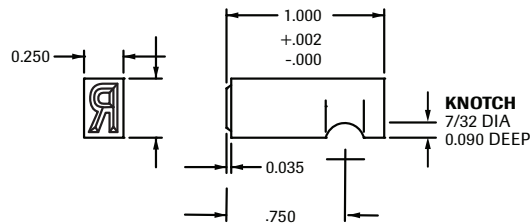

1/4" CHARACTER TYPE

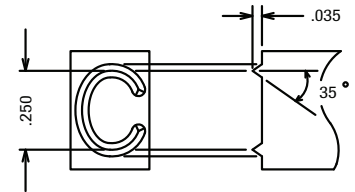

BLANK SIZE

1/16" = .093 x .250 x 1.000
 1/8" = .125 x .250 x 1.000
 3/16" = .187 x .250 x 1.000
 1/4" = .250 x .375 x 1.000

W-1 MATERIAL

CHARACTER SIZE

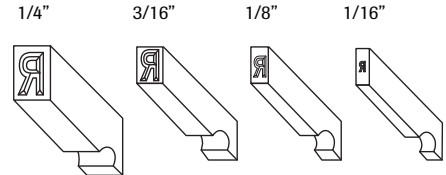

TYPE LETTER SETS

- Contains alloy letters from A-Z

Item No.	Description	Package
27640	1/2" Single Piece	Bagged
27630	1/16" Steel Type Letter Sets	Bagged
27632	1/8" Steel Type Letter Sets	Bagged
27634	3/16" Steel Type Letter Sets	Bagged
27636	1/4" Steel Type Letter Sets	Bagged
27638	3/8" Steel Type Letter Sets	Bagged

SINGLE TYPE PIECES

- Individual pieces are letters A-Z or numbers from 0-9

27630_	1/16" Single Piece	Bagged
27632_	1/8" Single Piece	Bagged
27634_	3/16" Single Piece	Bagged
27636_	1/4" Single Piece	Bagged
27638_	3/8" Single Piece	Bagged
27640_	1/2" Single Piece	Bagged

TYPE NUMBER SETS

- Contains alloy steel numbers from 0-9

27631	1/16" Steel Type Number Sets	Bagged
27633	1/8" Steel Type Number Sets	Bagged
27635	3/16" Steel Type Number Sets	Bagged
27637	1/4" Steel Type Number Sets	Bagged
27639	3/8" Steel Type Number Sets	Bagged
27641	1/2" Steel Type Number Sets	Bagged

TYPE BLANKS/SPACERS

- Used to separate letters, numbers or add spaces

27630BL	1/16" Blank Space	Bagged
27632BL	1/8" Blank Space	Bagged
27634BL	3/16" Blank Space	Bagged
27636BL	1/4" Blank Space	Bagged
27638BL	3/8" Blank Space	Bagged
27640BL	1/2" Blank Space	Bagged

Electric 2-Speed Pen Engraver

C.H. Hanson's 2-speed electric pencil engraver has a solid stainless steel body with a polymer ergonomic grip which provides comfort and ease of use. Its unique design provides a lightweight, slender and well balanced unit. With three types of engraving points and adjustable power, the most delicate to hardest material can be marked.

Item No.	Description	Weight
50002	Electric 2-speed pencil engraver	0.65 oz.

REPLACEMENT BITS:

50003	1 - HSS replacement bit
50004	1 - Carbide replacement bit
50005	1 - Diamond replacement bit

- Speeds 2
- Strokes per minute Low-3600/High-7200
- Voltage 110V
- Watts 8
- Point diameter 1/16" (.062)
- Tool length 7-1/4"
- Each unit includes one carbide, one HSS bit, and one diamond bit

